





**ROYAL LEPAGE**  
JMB & Associates

**Matt McSherry** REALTOR®  
**204-886-7585** (cell)  
mattmcsherry@royallepage.ca  
mattmcsherry.ca



Canadian,  
Owned &  
Operated!

AWARD WINNING SERVICE





**THE NARROWS - \$134,900**  
Lakeview 100x150' Lot w/883sf  
2 BR MH w/Sunroom. MLS #202508808



**TEULON - \$159,900**  
7 - 80 Lots to choose from - New  
Exurban Community! MLS #202509465



**BALMORAL - \$648,000**  
320 Acres w/1530 sf  
3 BR 2 Bath Home partially  
fin bsmnt. Wheelchair  
Accessible. 40 AC Hay  
remainder Pasture.  
MLS #202505297

# THE EXPRESS

WEEKLY NEWS

www.expressweeklynews.ca

VOLUME 12 EDITION 20 THURSDAY, MAY 22, 2025

LOCALLY OWNED HISTORY BOOK FOR THE COMMUNITY



**ALL IN STOCK NOW**

**2023 Honda CRF50**   
Air cooled single-cyl.  
49cc  
Reg \$2700  
**\$2,290<sup>00</sup>**  
INCLUDES FREIGHT, PDI AND FEES

**2025 Honda CRF 110 Bike**   
110 cc,  
Elec. start,  
Fuel inj.  
**\$3,890<sup>00</sup>**  
INCLUDES FREIGHT, PDI AND FEES

**2025 HONDA TRX420**   
RED  
**\$9,590<sup>00</sup>**  
INCLUDES FREIGHT, PDI AND FEES

**2025 HONDA RUBICON 520 DCT DELUXE**   
GREY  
**\$13,862<sup>00</sup>**  
INCLUDES FREIGHT, PDI AND FEES

**SHACHTAY SALES & SERVICE**  
Arborg, MB  
**204-376-5233**



Five-year-old twins Aleksey and Jaimesynn Kozminski-Kerbrat and their three-year-old brother Telle celebrated their birthdays with family and friends at Hausa Park, enjoying the sunshine and a turn on the bouncy castle.

EXPRESS PHOTO BY CORINNE EINARSSON

SERVING LUNDAR, ASHERN, ERIKSDALE, MOOSEHORN, FISHER BRANCH, RIVERTON, ARBORG, GIMLI, WINNIPEG BEACH, ARNES, MELEB, FRASERWOOD

**Countryside Home**  
 **building centre**  
Lot 1, Hwy 17 S, Fisher Branch, MB  
**204-372-8501**  
\*Plants may not be exactly as illustrated. No rainchecks.



**WOODEN PLAY STRUCTURE**  
Retail \$899.99  
Now  
**\$771<sup>00</sup>**  
(while supplies lasts)



## Arborg's Riverdale Place Workshop celebrates 50 years of caring for adults with intellectual challenges

By Patricia Barrett

Arborg's Riverdale Place Workshop invited the community to help it celebrate 50 years of caring for and providing employment to local and area adults with intellectual challenges.

The workshop's celebration last Friday included speeches from dignitaries, recognition of the dedicated staff who provide care to participants and a tour of the workshop. There was also food, live music and opportunities to chat with participants. One of the participants, Marilyn, has been part of the workshop for 48 of its 50 years. Some participants took to the dance floor with staff for an upbeat rendition of the song Stand By Me.

Interlake-Gimli MLA Derek Johnson attended the celebration and presented workshop manager Alex Janower with a plaque, congratulating the not-for-profit organization for its support and employment of adults with intellectual challenges, as well as recognizing the workshop's role in environmental stewardship through its recycling operation.

Janower has been with the workshop for 38 years and refers to it as a second family for him.

Selkirk-Interlake-Eastman MP James Bezan also attended the event and presented Janower and the workshop with a plaque for its 50 years of outstanding community service.

The workshop, which opened in May 1975, provides social services and paid employment opportunities to adults with disabilities in Arborg, Bifrost-Riverton and surrounding communities such as Fisher Branch and Poplarfield. In addition to learning skills and socializing with others, participants can take part in music, dancing, craft-making and other activities. Its recycling program serves the Town of Arborg and the Municipality of Bifrost-Riverton and helps keep the local landfill free of recyclable waste. In 2023, the workshop diverted over 235,000 kilograms of recyclables from the landfill.



Marilyn, who has been part of Riverdale Place Workshop for 48 of its 50 years, joined in the celebration marking the Arborg-based organization's milestone anniversary last Friday. The event featured speeches, live music, dancing and a tour of the facility.

The workshop saw its participant numbers decline with the onset of the COVID-19 pandemic. Participant attendance is funded by the provincial government, which earlier this year intended to stop funding the workshop but reversed course after a groundswell of opposition.

Johnson said he had nearly 120,000 hits on his Facebook page after he and his office embarked on a letter-writing campaign to encourage the province to continue its funding support for adults with intellectual challenges.

"Sadly, this NDP government is only renewing funding on a year-to-year basis," Johnson said a day after the 50th celebration. "Historically, they'd get multi-year contracts, ensuring budget support."



Selkirk-Interlake-Eastman MP James Bezan presents a plaque to Riverdale Place Workshop manager Alex Janower during the organization's 50th anniversary celebration.



EXPRESS PHOTOS COURTESY OF INTERLAKE-GIMLI MLA DEREK JOHNSON  
Interlake-Gimli MLA Derek Johnson congratulates Riverdale Place Workshop manager Alex Janower with a commemorative plaque.

The workshop itself has embarked on fundraisers to enhance participants' experience. In 2018, it raised money to purchase a van to take participants on outings in the community. And the family members of some clients have generously donated funds to buy items such as furniture.

The workshop is encouraging people with loved ones with intellectual

challenges to contact the facility for a tour and learn about the various activities, employment opportunities and social outings the workshop offers, as well as take time to meet the staff.

For more information about Riverdale Place Workshop and its programs, call 204-376-5584.



## Baker Law CORPORATION

Do you have a current will?

Protect your family by having a current will, power of attorney and health care directive. Call us or stop in for more information and find out how we can help you.

**Grant D. Baker**  
Barrister, Solicitor and Notary

Providing full time legal service to families and small businesses in Gimli and the Interlake.

### GIMLI LOCATION

72 Centre Street, Gimli, MB

Our office is open 8:30 am - 5:30 pm Mon to Thurs

204-642-8681 or 1-866-487-5688

### RIVERTON LOCATION

33 Main St. Riverton MB

Open Mon & Wed 9:30-4:30

204-378-5427

# Gimli council's 2025 budget expects increased revenue; spending almost \$13 million on projects

Property taxes increasing by 3.52 per cent on average for existing properties

By Patricia Barrett

Gimli council's 2025 budget is aiming to set the municipality on a course of growth and development while supporting community well-being over the long term.

Council expects to see almost double the amount of revenue it had brought in last year and will embark on ambitious capital spending to propel the municipality forward.

Council expects to bring in \$30,630,786 in revenue for this new fiscal year. In 2024, the RM's total revenue was \$17,345,732 and it spent a total of \$16,903,948.

Coun. Thora Palson, chair of finance and administration, presented the budget during a public hearing on May 13.

Palson said she's proud to see the RM take "bold steps" through a number of initiatives that will "mark the beginning of a new chapter of sustained growth and development for Gimli."

Those initiatives include the RM investing in local health services through the support of a new private medical centre, practising environmental stewardship through a wetland development project, improving connectivity in the RM through the enhancement of its outdoor trail system, and investing in digital infrastructure to improve communications, she said.

Mayor Kevin Chudd issued a state-

ment saying the budget "reflects our unwavering commitment to enhancing our community's infrastructure, public works, and recreational facilities. Our vision is to ensure Gimli remains a happy, comfortable, and safe place for everyone, while positioning ourselves as a premier destination in Manitoba."

The 2025 budget reflects council's priorities for programs and services in the new fiscal year and the overall strategic direction of the municipality. It also lays out projects it would like to get underway over the next five years. The budget, the financial plan presentation and the mayor's statement are available on the RM's website.

The financial plan presentation states council will continue to minimize taxation impacts and existing debt servicing so as not to place "undue financial burdens on its residents."

The RM's mill rate decreased from 14.788 to 12.527, a decrease of 2.261. However, 2025 provincial property assessments could result in some people paying more, fewer or about the same taxes.

The RM of Gimli's taxes will increase by 3.52 per cent on average for existing properties.

"Total municipal taxes are 4.53% higher than last year. Of this increase, 1.01% is generated from new assessments—such as new homes, businesses, and other developments coming on stream in 2025. This means the actual increase in taxes collected from existing properties (those that also paid taxes in 2024) is 3.52%," states the plan. "Reassessment may result in individual properties paying more, less, or about the same in taxes, depending on how their assessment



EXPRESS FILE PHOTO BY PATRICIA BARRETT

Road rehabilitation is one of council's priorities for 2025. The 2025 budget put aside \$700,000 for paved road renewal.

changed relative to the average. On average, municipal taxes are increasing by 3.52% for existing properties."

Rural property owners in the RM will pay about \$78 more in tax for a \$200,000 home.

"For a residential property assessed at \$200,000, the 2024 municipal taxes in the rural area were \$1,504. Considering an overall average of 21.5% increase in property assessment for 2025, the municipal taxes will be \$1,582. This represents an annual in-

crease of \$78.00 per \$200,000," states the plan. "The increase is due to the rise in the 2025 provincial property assessment."

Urban property owners in the RM will pay about \$80 more in tax for a \$200,000 home.

"For a residential property assessed at \$200,000, the 2024 municipal taxes in the urban area were \$1,551. With a 21.5% overall average increase in

Continued on page 10

**GRAND OPENING**  
This Saturday & Sunday May 24 & 25

**Save 20% off All Furniture, Mattress, and accessory purchases on May 24 & 25.**

**SEALE'S FURNITURE APPLIANCES**

Enter to Win a Set of 2 Adirondack Chairs  
Made of MEGA-TUFF® high-density polyurethane material and valued over \$600

74 1 Ave, Gimli, MB (204) 519-8342

**33rd Anniversary**  
**June 6 & 7 SALE**

Hot dog lunch June 6 11:30AM-1:00PM  
Pork on a bun June 7 11:30AM-1:00PM / Catered by Marble Ridge Colony

<b>PIT BOSS 850</b> Retail \$1,099.00 <b>NOW \$799.00</b> <small>While Supplies Last</small>	<b>MUCK BOOTS</b> <b>25% OFF</b>	<b>RUBBER MULCH</b> <b>10% OFF</b>
<b>PIT BOSS 1150</b> Retail \$1,199.00 <b>NOW \$999.00</b> <small>While Supplies Last</small>	<b>TREES &amp; SHRUBS</b> <b>20% OFF</b>	<b>Milwaukee TOOL SALE</b>

**REPS ON SITE:**  
 • Husqvarna • Exchange-A-Blade  
 • IKO Shingles • Bissett Fasteners  
 • Owens Corning • Shercom  
 • Milwaukee • Mitten Siding

**FREE COFFEE AND DONUTS BOUNCY CASTLE**

**ENTER TO WIN A FREE Pit Boss 550 with every \$100.00 pre-tax purchase**

**Countryside Home building centre**

Lot 1, Hwy 17 S, Fisher Branch, MB  
204-372-8501

# Tea, treats and trendsetting for a cause in Arborg

By Lana Meier

Fashion and philanthropy came together under one roof as the Arborg Legion Ladies Auxiliary #161 hosted its annual spring tea and fashion show in support of local causes last Thursday.

The event featured 15 volunteer models ranging in age from 18 to their mid-80s, who confidently strutted the runway in stylish outfits provided by Johnson's Clothing Store in Gimli. Approximately 100 guests attended — down slightly from last year due to the Winnipeg Jets playoff game and the rainy weather.

Guests were treated to tea, fancy ribbon and pinwheel sandwiches, cheese, pickles and desserts, all made by auxiliary members, while raising funds for several community organizations.

"This year, Johnson's brought 64 different outfits to model. They have done this for years for us and we are so grateful," said president Marlene Taylor.

In addition to the fashion show, the event featured a silent auction with items donated by local businesses and members, and a raffle with three cash prizes: \$300, \$200 and \$100. All proceeds from the Spring Tea and Fashion Show — including clothing sales, raffle and auction revenue — will go toward organizations including assisted living, the Arborg Rec Centre, the food bank, Arborg Street Festival, the Arborg Ag Fair and, this year, STARS air ambulance.



Kim Magnusson from Johnson's Clothing Store in Gimli.

"We had an incident in town and someone was injured in an ATV accident and was airlifted to Winnipeg. We wanted to give back to show our support," said Taylor.

The Ladies Auxiliary, made up of just 18 active members, is well known in the community for its commitment to giving back. In addition to the fashion show, the group organizes community raffles and catering services to support its fundraising efforts.

The ladies meet monthly at the Legion hall on the last Tuesday of each month at 2:30 p.m., and always welcome new members. Anyone interested can contact Taylor at 204-376-5607.

"If you like to volunteer and give back to the community, we are the perfect organization," said Taylor.



EXPRESS PHOTOS BY CORINNE EINARSSON

Shelby Isfeld models one of 64 stylish outfits provided by Johnson's Clothing Store during the Arborg Legion Ladies Auxiliary's annual spring tea and fashion show, held May 9 in support of local causes.



Community volunteers modelled the clothing.

Clockwise from top left: Colleen Sigvaldason, Karen Leochko, Val Martin, Lillian Skulason, Katie Jones and Janet Helgeson.

# IWRC extends mobile counselling and support programs to Fisher Branch

By Emma McGill

The Interlake Women's Resource Centre (IWRC) has expanded its reach once again, adding Fisher Branch to the growing list of communities it serves. With this addition, the IWRC now supports individuals across 14 towns in southern Manitoba.

The decision to expand north was driven by demand, as clients from the Fisher Branch area were already travelling to access services elsewhere.

"We have had an overwhelming number of clients accessing the centre, and often for more than just family violence," said IWRC executive director LiAnne Snow. "We are continuously exploring ways to expand our programming to better meet the

diverse needs of the communities we serve."

The IWRC was first established 41 years ago as a grassroots initiative in Gimli and Riverton, providing support to women experiencing domestic violence and abuse. In the early days, a small team of volunteers offered crisis support, transported clients to shelters, and educated individuals about the cycle of violence. The organization was renamed in 1991, evolving from the Interlake Spouse Abusal Committee to its current form, and hired a second outreach worker a few years later to meet rising demand.

Today, its services have grown far beyond crisis response. The IWRC now offers mobile counselling, with

the help of rural partners that donate office space as needed, as well as regular programming like yoga, beading workshops and a widow's group. A community cupboard is also available, stocked with essential items for those in need.

"This new location allows us to expand our reach and provide more accessible support to individuals and families facing challenges related to family violence and mental health," said Snow.

The organization's mission has also broadened to support people of all gender identities. "Everyone deserves access to support, regardless of gender, background or circumstance, and I'm proud to contribute to a place

that truly embodies that belief," said Snow.

IWRC now operates full-time from a three-bedroom bungalow at 87 5th Ave. in Gimli — a space that was donated to the centre in 2006.

"Working at Interlake Women's Resource means so much more to me than just a job — it's a passion," Snow added. "Creating a safe, welcoming, and inclusive space where people feel seen, heard and valued is something I care deeply about."

To book mobile counselling or access services in any of the 14 communities, individuals are encouraged to call the Gimli office and mention their location.

## Manitoba Hydro repairing damage, restoring power in wildfire zone



PHOTO SUBMITTED

Manitoba Hydro crews are restoring power in eastern Manitoba, where burned poles, downed lines and inaccessible roads have impacted service for hundreds of customers.

By Lana Meier

Manitoba Hydro crews are working to restore power in areas of eastern Manitoba affected by wildfires, including parts of the Lee River area

and Wendigo Road.

About 900 customers along the Lee River had power restored late Wednesday, but roughly 500 others remained without electricity Thursday morning as fires continued to impact infrastructure.

Crews are now gaining access to areas with significant damage, including burned and downed poles, power lines, transformers and other equipment. Construction teams staged in Lac du Bonnet overnight and began repairs Thursday morning where access became possible.

Due to the extent of the damage, Hydro says repairs may be complex and it is too early to estimate full restoration times.

Meanwhile, Manitoba Hydro evacuated its generating stations at Pointe du Bois and Slave Falls late Wednesday as wildfires threatened road access. The facilities were safely shut down, with generating units offline and water flowing through spillways. The loss of generation will not affect customers, the utility said.

Hydro continues to monitor the evolving wildfire situation, with aerial patrols underway to assess further damage.

## Record-breaking weather



EXPRESS PHOTO BY LYNDA KELLY

Manitoba experienced a record-breaking heat wave last week, with 13 communities setting new records on Tuesday, May 13. Gimli was among the record setters, reaching 36.2 C. The previous record was 33.3 C set in 1977. The heat led to days of rain, and brought Gimli its first rainbow of the year.

On May 17 Gimli experienced notably cool and overcast conditions, -3.3 C. These temperatures were significantly below the seasonal average for mid-May in Gimli, when typical highs are around 18 C.

**Story Idea?  
News Tips?**  
call the Express  
204-467-5836

### South Interlake ATV Club (SIATV)

Do you enjoy Quadding and the outdoors, meeting new people and travelling through Canada's back country? Creating lifelong memories and friends in the process.

The SIATV was the first ATV club in Manitoba and the Interlake Pioneer Trail was the first designated multiuse trail in Manitoba. The Interlake Pioneer Trail has been managed and maintained by the SIATV Club as a multiuse trail for all to use since 2009.

ATV'S and Side by Sides can ride from Stonewall to Fisher Branch through the R.M.'s of Rockwood, Woodlands, Armstrong and Fisher. Through farmland to the Boreal Forest, past the Narcisse Snake Dens, Inwood, Chatfield, Broad Valley and Fisher Branch.

We offer a safe and fun place to ride.

**For More Information Contact:**

Cam @ (204) 651-1464

Facebook: South Interlake ATV Club (Group)

Email: southinterlakeatvclub@gmail.com

 **Winnipeg Beach Legion Br. 61**  
20 Hamilton Avenue, Winnipeg Beach

**Pancake Breakfast**  
May 25 8:30 a.m. - 11:30 a.m.

**Spring Craft Sale**  
June 22 10:00 a.m. - 3:00 p.m.  
Various Crafters, Vendors, Ukrainian Food, Baking, and more!

To book tables call 204-389-2660 and leave message or email rclbr61@gmail.com.  
www.winnipegbeachlegion.ca  
50/50 Draw All events are cash only

You have options.

  
**KEN LOEHMER**  
FUNERAL SERVICES

55 Main St, Teulon Call 204-886-0404 or visit www.klfuneralservices.ca

THE EXPRESS  
WEEKLY NEWS**PUBLISHER**  
Lana Meier**SALES**  
Brett Mitchell**REPORTER/PHOTOGRAPHER**  
Kieran Reimer**REPORTER/PHOTOGRAPHER**  
Jennifer McFee**ADMINISTRATION**  
Corrie Sargent**REPORTER/PHOTOGRAPHER**  
Patricia Barrett**PRODUCTION**  
Nicole Kapusta**DISTRIBUTION**  
Christy Brown**PRODUCTION**  
Debbie Strauss**ADMINISTRATION**  
Jo-Anne Procter**PRINT**  
Dan Anderson**ADMINISTRATION**  
Allana Sawatzky

## OUR SISTER PUBLICATIONS

Stonewall Teulon  
**Tribune**  
**Selkirk Record**The Carman-Dufferin  
**STANDARD**The Winkler Morden  
**Voice**The Altona & Winkler  
**Voice**

# get informed

NEWS &gt; VIEWS &gt; GIMLI &gt; ARBORG &gt; HIGHWAY 6 &gt; SURROUNDING AREAS

## Policy matters

**By Cam Dahl, general manager, Manitoba Pork Council**

A former prime minister once quipped from the campaign trail that “an election is no time to talk about serious issues.” When it comes to providing opportunities for Canadians, however, policy matters far more than partisan politics. We have had a federal election, and a cabinet has been appointed. We now need the government to have a laser-like focus on the fundamentals of good policy.

I have heard farmers express the view that agriculture is an afterthought around the cabinet table. The sector makes up about seven per cent of the Canadian gross domestic product, or \$150 billion per year, and employs 2.3 million Canadians, representing one in nine jobs across the country. An acknowledgment by the whole cabinet of the critical contribution that agriculture makes to the Canadian economy would be a good way for the new federal government to offset farmers’ frustration about the placement of agriculture in national policy priorities.

Trade must be the priority issue for the new minister of Agriculture and Agri-Food. In 2024, Canadian agriculture and food exports exceeded \$100 billion, yet the policies that will support and expand Canadian agriculture and food exports are not always considered when Canada’s trade positions are set. A positive key first step signaling a shift in focus for agriculture policy would be the explicit inclusion of agriculture in the “Team Canada” missions that are part of our outreach with U.S. customers and policy makers.

While agriculture, like most Canadian industries, has rightfully focused on the threat of U.S. tariffs in the past

few months, protectionism is growing around the world. Canadian pork and seafood exports to China face a 25 per cent tariff. Canola products have been hit with a 100 per cent tariff by the Chinese government. Canadian agriculture and food exports have been sidelined by European non-tariff barriers, despite the Canada-European Comprehensive Economic and Trade Agreement (CETA). Growing protectionism is compounded by rising political uncertainty, with the war in Ukraine and instability in the Middle East just two examples. Canada needs a strategic plan to deal with these threats.

The new federal minister of Agriculture and Agri-Food, Heath MacDonald, could hit the ground running if he were to set up, together with representatives from export agriculture, a task group with the mandate to develop a strategic plan for agriculture and agri-food trade. This joint government and industry task group should set out to answer three basic questions. First, in the short term, how does Canada mitigate the impact of tariffs and potential tariffs on agriculture and food exports? Second, what is the strategic plan to eliminate non-tariff and tariff trade barriers currently blocking Canadian agriculture and food exports? And third, what is the strategic plan to diversify markets for Canadian agriculture and food exports?

The overarching goal of the task group should be to set out a clear plan that will preserve the integrated North American market for agriculture and food products, and to eliminate tariff and non-tariff trade barriers around the world.

The effort to develop a strategic plan for agriculture and food trade cannot only be carried out by governments. There is also work to be done by farm groups and industry stakeholders. There are over 400 farm groups

across Canada. This means that governments do not always receive a coherent consensus position from the sector. It is incumbent upon farmers, those who represent farmers, along with food processors and manufacturers, to develop clear policy proposals aimed at the expansion of agriculture and food exports. If the minister receives 400 different opinions, they face a risky policy position where any action would be subject to opposition by somebody. Lack of consensus within agriculture opens the door for governments to do nothing.

Agriculture and food trade is not just a matter of economic policy, it is also a national security issue, given the increasingly less stable geopolitical environment. This is especially true for the three countries who are signatories to the Canada-U.S.-Mexico Agreement (CUSMA). Canadian farmers can help deliver a reliable and safe food supply for consumers. This value from Canadian agriculture must be demonstrated in the strategic plan for agriculture and food trade and emphasized in upcoming trade discussions, including the impending review of CUSMA.

The recent election campaign saw the major parties promising a new approach to trade policy to respond to growing protectionism in both North America and around the world. The new federal government, including the new minister of Agriculture and Agri-Food, has an opportunity to put these promises into action for farmers, processors and the millions of Canadians who work in the sector. Current disruptions to world trade can be turned into opportunities for Canadian agriculture but only if we see bold and decisive policy. The alternatives will be bad for farmers, bad for Canadian value-added processing and undermine the potential for growth in the Canadian economy.

## ADVERTISING OR PRINT

## CONTACT INFORMATION

Lana Meier 204-292-2128  
ads@expressweeklynews.ca

PHONE 204-467-5836

FAX 204-467-2679

## OUR EDITORIAL STAFF

Patricia Barrett -

Reporter/Photographer

Cell 204-407-6099 patricia@expressweeklynews.ca

## PAPER DELIVERY OR FLYER CONCERNS

Christy Brown, Distribution Mgr.: 204-467-5836

The Express Weekly News is published Thursdays and distributed through Canada Post to 11,396 homes. Republishing in whole or in part without permission is strictly prohibited. Printed in Canada by Prolific Printing.

This newspaper is supported 100% by advertising dollars. If you enjoy the paper and would like to see the newspaper grow and prosper visit any of the advertisers and businesses in our rural communities. - Keep your dollars working at home and shop local. Our commitment to you, the reader - we connect people through stories to build stronger communities.



## &gt; EMAIL US

Letters to the Editor: news@expressweeklynews.ca

Classifieds: ads@expressweeklynews.ca

News: news@expressweeklynews.ca

Print: igrphic@mymts.net

Funded by the Government of Canada

Canada

## ADDRESS

74 Patterson Drive, Stonewall Industrial Park  
Box 39, Stonewall, MB R0C 2Z0

Advertising Deadline: Monday 4:00 pm  
prior to Thursday Publication

View the Express Weekly News online at  
[www.expressweeklynews.ca](http://www.expressweeklynews.ca)

# Bifrost-Riverton byelection candidates announced, voting date set

By Patricia Barrett

Candidates running in a byelection in the Municipality of Bifrost-Riverton council have been announced and dates set for voting.

Larry Brandt and Kirk Johnston are running for the Ward 1 seat, which was left vacant when former councillor Shawn Magnusson stepped down.

The byelection is scheduled for Wednesday, June 18 at the Riverton Curling Club, 175 Reggie Leach Dr. in Riverton, from 8 a.m. to 8 p.m.

Residents who won't be able to vote on voting day have the option of vot-

ing in advance. Advanced voting will take place on Saturday, June 7 at the Riverton Curling Club from 8 a.m. to 8 p.m.

Residents who can't vote in person have the option of voting by sealed envelope. They must apply in person, in writing or by email to senior election official (SEO) Jan Larkin: 329 River Rd., Box 70, Arborg, MB, R0C 0A0. Email: janlar5001@gmail.com

Those applying for sealed envelope voting in person can do so between June 2 and June 13. Those applying

for sealed envelope voting by mail or email can apply between May 23 and June 13. They will receive the package by regular mail or by making other arrangements with the SEO.

Residents should be aware that there could be a Canada Post strike announced this week depending on how negotiations with the Canadian Union of Postal Workers go for a new collective agreement, and that this could possibly affect applications made by post for a sealed envelope.

For more information about the bye-

lection and voting, contact SEO Jan Larkin at 204-641-0329.

## Classrooms can 'tackle finances' with Access CU and Winnipeg Bomber-led workshops

By Annaliese Meier

Manitoba classrooms have a chance to score a touchdown in financial literacy, thanks to a returning partnership between Access Credit Union and the Winnipeg Blue Bombers.

Schools across the province are invited to apply for the "Tackle Your Finances like a Pro" workshop — an engaging, 60-minute session co-led by an Access Credit Union Financial Literacy trainer and a Winnipeg Blue Bombers player.

Back for the 2025-26 school year, the workshop uses interactive activities to help students build practical

money management skills. Exciting giveaways and prizes are also part of the experience.

"These workshops were introduced last year to great success. We found students were very engaged, asked thoughtful questions and showed genuine interest in learning how to take control of their financial future," said Emily Suderman, financial literacy specialist at Access Credit Union.

Last year, Blue Bombers receiver Nic Demski attended every workshop — a highlight for many of the participating students.

"We are excited with all the interest

from the local schools for the Financial Literacy Program and look forward to building on last year's success," said Wade Miller, president and CEO of the Winnipeg Football Club. "We are thrilled to be in partnership with Access Credit Union on this important community initiative."

Schools interested in applying can visit [accesscu.ca/bombers](http://accesscu.ca/bombers). The application deadline is June 30.

Access Credit Union, the largest credit union in Manitoba, serves more than 205,000 members with \$13.49 billion in assets and a provincewide network of branches.

### Community Support Service

#### A.A Meeting in Ashern

Location: #11 2nd Ave North  
- Pioneer Manor  
(beside the main door entrance of Pioneer Manor)  
Contact Jackiem.lwrc@gmail.com

#### AA Arborg

Thursdays - 7:30 pm  
Arborg Support Centre  
327 Main Street  
Contact 204-376-5861

#### AA Eriksdale

Eriksdale United Church building  
#7 Main Street, Eriksdale (side door)  
Meetings are Mondays  
at 6:30 p.m.

#### AA Winnipeg Beach

Lady of the Lake RC Church  
Corner of Hwy. 9 and Lake Ave.,  
Winnipeg Beach  
Meetings are Saturdays  
between 7 and 8 p.m.  
Contact Ann J 204-389-3417

#### Gimli Group AA

Bldg 18 Municipal Rd  
Industrial Park  
Fri & Sun Mtgs at 7:30 pm

#### Al-Anon Gimli and Winnipeg Beach

Join us at 17B Loni Beach Road, next to New Horizon building... Gimli at 7:00 pm Wednesday evenings for an hour of support, strength, guidance and Hope. Contact 204-389-4777.  
All ages welcome.

#### AA Riverton Group

12 Main St. at the  
Riverton Senior Centre  
Mondays 7:30 p.m.

### GEYSIR CEMETERY DONATIONS SOUGHT

We are seeking donations for the 2025 grass cutting season. Please help keep our cemetery maintained by sending a cheque payable to:

**Geysir Cemetery Fund**  
Box 796, Arborg, Mb, R0C0A0

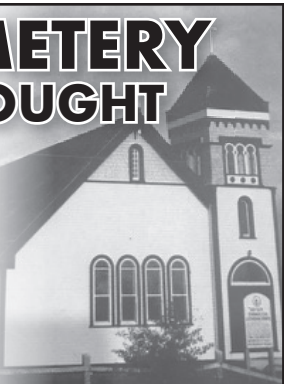

### TOM KOSTER DENTURE CLINIC



Denturist

- We accept the Canadian Dental Care Plan and all other dental plans
- Arborg Clinic - 356 River Rd.
- Phone (204) 376-5838 for appointment
- After hours (204) 781-6409



Marilyn Crewe  
Economic Development Officer  
Neepawa, MB

GOOD FOR  
**ME**

Watching my community thrive demonstrates the hog sector's commitment to rural Manitoba.

GOOD FOR  
**MB**

Manitoba's hog sector contributes 22,000 jobs and \$2.3 billion annually to the provincial GDP.





# Spring Home & Garden Guide



## 4 annuals that will add height to your flowerbeds

Annuals often feature abundant blooms that are positively eye-catching. While it's relatively easy to find low, medium-sized flowers, it can be difficult to get your hands on large, majestic ones. Here are four annuals that stand tall and proud.

1. **Dahlia.** Some varieties of this beautiful flower can grow up to two metres in height. However, it's best to stick to a single colour and find



a type that doesn't grow taller than one-and-a-half metres.

2. **Cosmos.** This thin and delicate flower is available in beautiful pastels like white and pink. It'll wow your neighbours and attract butterflies and birds to your yard.

3. **Cleome.** This beautiful ball-shaped flower is often overlooked at greenhouses and nurseries because it rarely blooms at the start of spring. Give it a chance — you won't regret it.

4. **Canna.** This bulbous plant tends to bloom late in the season. Therefore, it's best to plant it indoors four to six weeks before the last frost. Better yet, you can buy dwarf varieties that fill out quickly.

Horticulturists and landscapers generally recommend limiting yourself to two or three colours and three or four species to maximize their visual impact.

## Tips for gardening in a shady yard

Even if your yard doesn't get much sunlight, it's still possible to grow a beautiful garden. The key is to select shade-tolerant species. Here are some suggestions.

### Perennials

In addition to hostas, which thrive in shady conditions, many perennials don't require much sunlight. Consider planting:

- Leopard plants, whose yellow flowers are sure to brighten dim spaces
- Coral bells, which are great for lining the edges of a flower bed
- Undergrowth ferns such as ostrich, lady and wood ferns
- Bugbane, which has spikes of wispy white flowers on tall stems
- Forget-me-nots, which have

beautiful blue springtime blooms

There are also a number of ground cover plants that are well-suited for shady conditions such as bugleweed, lily of the valley and creeping dogwood.

### Shrubs

There are several types of ornamental shrubs that can add height and texture to a shady garden, including:

- Holly
- Dogwood
- Squirrel corn
- Rhododendrons
- Some hydrangeas

In addition to looking for shade-tolerant species, be sure to consider the hardiness zone you live in when selecting plants for your garden.

## Spring heat surge



EXPRESS PHOTO BY LAREINA UNGER

A hummingbird moth feeds on marigolds during Monday evening's heat wave, as temperatures soared to 36.2 C with strong south winds across the region. The extreme heat was part of a broader weather pattern affecting southern Manitoba, with several communities reporting record-breaking temperatures. Help the *Express* record the weather — send your photos of friends and family enjoying the outdoors to [news@expressweeklynews.ca](mailto:news@expressweeklynews.ca).



- Bedding Plants and Baskets
- Perennials
- Fruit Trees, Shade Trees and Shrubs
- Garden Centre
- Gift Shop and Garden Decor
- Houseplants, Succulents, Cactus
- Seed Potatoes, Seeds, Onion Sets
- And so much more...

Open: 10:00 am  
until 7:00 pm  
7 days of the week

6 km east of Hwy 6 on P.R. 229  
20,003 Road 108 North (Clarkleigh Road)  
(204)762-5879 [www.sabadosgreenhouse.ca](http://www.sabadosgreenhouse.ca)  
Visa, Mastercard, Interac,  
American Express accepted

Find us on  
Facebook



# Spring Home & Garden Guide



## Five tips for taking care of rose bushes



Roses can easily become the star of your garden. While the climbing varieties are tricky to care for, rose bushes present less of a challenge. Here are some tips for taking care of them.

### 1. Water them sufficiently

Roses need to be watered on a regular basis, especially in the spring. Do so early in the morning and apply mulch to help the soil retain moisture. Water the base of the plant to avoid getting the leaves wet.

### 2. Fertilize them sparingly

Rose bushes don't need to be fertilized every year. However, if the soil is lacking in nutrients, you can apply a natural, nitrogen-rich fertilizer in the spring to stimulate new growth. In July, opt for a phosphorus mixture to promote flowering.

### 3. Prune them annually

In spring, remove branches that are diseased, damaged or growing in-

ward before the buds open. Keep healthy canes but cut them back by about a third of their length. Always prune just above a bud that's pointing outward from the plant.

### 4. Rejuvenate them periodically

Rose bushes benefit from being severely pruned back every five years or so. This is an effective way to rejuvenate the plant and encourage new growth. Identify a few older canes and cut them just above ground level.

### 5. Check them frequently

Rose bushes are susceptible to diseases such as powdery mildew, rust and black spot. They also attract a number of harmful insects including aphids, caterpillars and beetles. Inspect your plants regularly and treat them as needed.

Find everything you need to care for your rose bushes at your local nursery or garden centre.

## Make your yard a paradise for pollinators

Habitat loss is one of the main causes of decline in the population of bumblebees and other pollinators. If you want to help protect these vital species, consider growing nectar plants in your yard. This will provide a food source for the insects and birds that pollinate your community's gardens, orchards and fields.



### Choosing plants

There are many kinds of flowering species that can beautify your yard while also creating an inviting space for pollinators. Sunflowers, anemones, goldenrods, echinacea and hydrangeas are all great picks. Pollinators are attracted to a number of annuals as well, including borage, centaury and cosmos.

If you prefer to grow food in your garden, consider planting aromatic

herbs like oregano, sage and thyme. Fruit trees and plants, such as apple, blueberry and strawberry are a good source of nectar in spring.

### Additional advice

If you want to attract pollinators to your yard, be sure to:

- Grow nectar plants in areas that are sheltered

from the wind

- Include white flowers in your garden to attract nocturnal pollinators
- Provide a source of water such as a small fountain or birdbath
- Avoid weeding dandelions, clovers and ivy; they're rich in nectar
- Plant species with varied bloom times so you have flowers from spring to fall

By following these tips, you're sure to create a welcoming environment for all kinds of pollinators.

GIFT CARDS AVAILABLE



**FOR ALL YOUR GARDENING NEEDS**

In Arborg Hwy #68 West



GIFT CARDS AVAILABLE

## Bedding Plants, Trees, Baskets, Natural Fertilizers & much more.

1/4 Mile West of Hwy #7 on Hwy. #68, 1/8 mile south on Hatchery Road.  
**Mon. to Sat. 9 am - 7 pm**  
[friendlyflowersgc.com](http://friendlyflowersgc.com) Phone: (204) 376-2727

## Ashern Home Hardware

# Greenhouse

## Now Open!

**FULL SELECTION OF TREES & SHRUBS HAVE ALREADY ARRIVED!**

**FULL SELECTION OF FLOWERS AND VEGGIES**



*Special orders are welcome*



**ASHERN Home hardware**  
LOCALLY OWNED

#28 RAILWAY AVENUE  
 ASHERN  
**204-768-3980**  
[HOMEHARDWARE.CA](http://HOMEHARDWARE.CA)

## > GIMLI BUDGET, FROM PG. 3

property assessment for 2025, the municipal taxes will be \$1,631. This results in an annual average increase of \$80 per each \$200,000," states the plan. "The increase is due to the rise in 2025 the provincial property assessment."

The province replaced the education property tax credit with the homeowners' affordability tax credit, which offers "up to \$1,500 in school tax relief" for principal residences. Seasonal properties will no longer receive education tax rebates, returning to pre-2021 norms.

Property owners outside Winnipeg can access their 2025 assessment on the province's website by creating an account on the MyPropertyMB digital portal.

Council intends to spend almost \$13 million (\$12,812,620) on capital projects in 2025.

Of that \$12.8 million, \$582,500 will be borne by borrowing and \$12,230,120 will be borne by the general fund.

Capital projects include a needs assessment for the public works facility (\$50,000), a lighting retrofit at the Evergreen Library (\$13,000), pick up tracks [sic] (\$70,000), Grader MG33 (\$574,031.46), wheeled loader (\$310,000), lighting in the central business district and Second Avenue parking lot (\$300,000), Fifth Avenue sidewalk between Lady

of the Lake and Centre (\$75,000), paved roads renewal (\$700,000), electrical lighting for Viking Park (\$40,000), road sweeper (\$200,000), dormitory [sic] commercial appraisal (\$15,000), banners and flags and other ceremonial items to develop cultural inclusion (\$10,000), wastewater treatment plan concrete restoration works (\$250,000), Fourth Avenue watermain (engineering) \$40,000 and renewal (\$2,330,000) that will be cost shared with Manitoba Water Services Board, fire department aerial platform truck (\$1,672,000), floor cleaner (\$15,000), trailer (\$20,000), hall water system (\$4,500), training ground improvements (\$20,000), wildland gear (\$10,000), airport resurfacing (\$50,000), Gimli recreation and leisure youth hub (\$250,000), Fitness centre designs (\$25,000) and goal [fitness centre] \$943,032.50, beach walkway and boardwalk lights (\$300,000) and promenades (\$148,992), site plan recreation plaza and strategic plan plaza goal (\$2,000,000), municipal building stairs (\$50,000), wetland site prep (\$50,000), wetland strategic plan conceptual drawings (\$45,000) and wetland strategic plan community visioning (45,000).

Over \$7.2 million (\$7,271,926) was transferred out of the RM's reserve funds.

The opening balance of the RM's general reserve fund had \$4,455,055 and \$3,688,538.73 was transferred out. The opening balance of the equipment reserve was \$1,994,382 and \$948,015.73 was transferred out. The opening balance of the amalgamated accumulated surplus reserve had zero. The road reserve fund's opening balance was \$2,798,441 and \$750,000 was transferred out. The federal gas tax reserve opening balance was \$1,830,524 and \$320,000 was transferred out. The building reserve opening balance was 1,947,651 and \$1,089,088 was

transferred out. The fire reserve fund opening balance was \$950,796 and \$185,331 was transferred out. The Industrial Park Reserve opening balance shows 1,137,819 and no money was transferred out. The Multiplex/Recreation Reserve opening balance was \$290,953 and all of it was transferred out.

The *Express* reached out to Coun. Richard Petrowski for comment on the budget as he wasn't able to attend the public hearing.

"I would like to thank all the staff that stepped up during this challenging time to put the budget together by the deadline," said Petrowski, referring to the recent resignations of former CAO Trilbee Stirling-Kattler and a senior finance person, both of whom had been working on the 2025 budget.

Petrowski said he voted in favour of the budget — he voted by telephone — although he has some concerns with it.

"I did support the budget even though I do have concerns about certain aspects of it such as the amount coming out of reserve funds, the hiring of consultants and the high cost for legal services," said Petrowski. "But it's important that we as council members have to make concessions in order to come to a consensus so that we can move forward."

The budget meeting included a presentation and 2025 recreation budget from Brenna Philp, the RM's director of recreation and leisure, and a presentation from Ron Hahlweg, the RM's director of operations.

The *Express* reached out to the RM's interim CAO Ernie Epp, asking where the anticipated increase in total revenue for 2025 is coming from and whether the RM has a policy regarding reserve funds.



**Interlake's Automotive & Agricultural Glass Specialists**  
We make the claim  
We replace the glass  
We have courtesy cars available

 **Manitoba Public Insurance**  
Autopac Accredited Glass Repair

 **Stonewall Glass** Phone 204-467-8929  
to book your appointment.  
2 Patterson Drive, Stonewall

## Advances in technology are making for overall better dentures

By Elisha Vondor

About 6-months ago, if you would have asked me the better way to make dentures, I would have said analog (hand-made) is still the best way to go simply because of the artisan work involved in creating a custom unique smile that's non-replicable. Overall, that information was based on my naive knowledge of denture fabrication and the advancements in technology. Yes, hand-made dentures can still be the best dentures you've ever had, but there's something to say about digital (milled) dentures these days. After attending the largest dental and denture convention in North American back in February, purchasing digital denture equipment and software prior to that and using it for over 6-months now to fabricate dentures, well, I have noticed that the advancements in the technology and materials used for digital dentures is quickly becoming better all the time.

So, if you're wondering, what is a digital denture? Digital simply means using computer software and equipment to scan the mouth and build the denture from the scan. The ongoing advancements in technology to improve the digital denture process had me saying 'wow' when I saw the Denturist using strokes of the computer mouse to shape and mould the gums of a patient's denture to perfection. The software really does mimic the way one would create the denture by hand.

Both Brigitte and her mom Bella (featured in the photo) received new digitally made dentures from Vondor Denture Centre and actually Bridette is wearing an upper denture for the first time! She said, "I can actually smile big now without being self-conscious of the missing teeth and it fits like a glove. I'm very comfortable with it. I got the white teeth that I wanted." For Bella, it had been 20 years since she last re-

placed her dentures. She explained that her mouth was caved in, but now the dentures fill her lips. They even took a few wrinkles away and are very natural-looking. A few other benefits of digital dentures are:

- A better fit.
- Stain-resistant.
- Stronger, more durable material with a 3-year warranty against breakage.
- If you lose a denture or the dog eats it, both scenarios I've heard this week, then a replacement is half the cost because the digital scans are already in our computer software.

A digital denture is still a denture, so it is accepted by all insurance plans including the Canadian Dental Care Plan. Both Bridette and Bella used their Canadian Dental Care Plan insurance towards their new digitally made dentures. We look forward to seeing you soon for your free denture consultation.



Bella and Bridette pose with Denturist Brock (from left to right) at Vondor Denture Centre after receiving their new digital dentures.

VANDOR • DENTURE • CENTRE

AWARD-WINNING DENTURES AND IMPLANTS

299 1/2 EATON AVE. SELKIRK, MB  
**(204) 482-6698**



# Federal Liberal government to provide income tax cut to help with cost of living

By Patricia Barrett

The federal Liberal government announced last week that it will bring in legislation to provide a tax cut for nearly 22 million Canadians.

Finance and national revenue minister Francois-Philippe Champagne announced the tax relief measure last Wednesday, saying Canadians expected to see a plan for change to address the high cost of living when they voted for a Liberal government, and that the government is now delivering that change.

The tax cut aims to provide relief to middle-class workers. Those with incomes in the two lowest tax brackets — those with taxable income under \$114,750 in 2025 and those with taxable income of \$57,375 and below in 2025 — will receive the bulk of the tax relief measure.

“With today’s middle-class tax cut, we are setting the stage for economic growth by helping hard-working Canadians keep more of their paycheques to spend on the priorities that matter most to them. Every Canadian should be able to afford necessities, feel secure and get ahead financially — and this tax cut will help them do just that,” said Champagne in a May 14 news release. “As Canadians continue to feel the impact of ongoing challenges including trade and tariff

uncertainties, they should be able to keep more of what they earn to help build a stronger future and a more resilient Canada.”

Once legislated, the lowest marginal personal income tax rate will be reduced from 15 per cent to 14 per cent effective July 1, states the news release.

The tax cut is expected to deliver over \$27 billion in tax savings to Canadians over five years, starting in 2025-26. Two-income families are expected to save up to \$840 a year in 2026.

To reflect a one-percentage-point cut in the lowest tax rate coming into effect halfway through the year, the full-year tax rate for 2025 will be 14.5 per cent and the full-year rate for 2026 and future tax years will be 14 per cent, states the release.

The Canada Revenue Agency will update its source deduction tables for the July to December 2025 period so that pay administrators are able to reduce tax withholdings as of July 1. This means that, effective July 1, individuals with employment income and other income subject to source deductions could have tax withheld at 14 per cent. Otherwise, individuals will realize this tax relief when they file their 2025 tax returns in spring 2026.

**SELKIRK STEELERS**  
**MONSTER**  
**BINGO**

**FULL HOUSE**  
**MINIMUM**  
**\$10,000**

**FRIDAY, JUNE 6, 2025**  
**Selkirk Rec Complex - Ice Surface**

**Tickets available at:**  
• Selkirk Record  
• Roxi's Uptown Cafe  
• World of Water Selkirk  
• Essential Cannabis Company  
**or by email:**  
bingo@selkirksteelers.com  
**ALL POTS MUST GO!**

Lottery Licence Number: #LSCA 899-BI-47536

*Explore* a New Corner of the World

**SUNSEEKERS TRAVEL PRESENTATION**  
WORLD TRAVEL

**Thursday May 29<sup>th</sup> 2 pm**  
**Gimli New Iceland Heritage Museum 94 - 1st Ave.**

**Highlighting:**  
**EUROPEAN RIVER CRUISE**  
Sail from Prague to Budapest. Explore Czech Republic, Germany, Austria, Slovakia & Hungary.

**AFFORDABLE SPAIN WINTER GETAWAY**  
Feb 15 & Feb 18, 2026 Departures  
3 weeks includes airfare, condo & transfers **From \$3,049** + taxes

**Early Booking Bonus, SAVE \$2,100.00**

**RSVP to Connie Szczerba at 204-223-9167 or email connie@sunseekers.ca**

**FARM to FORK**

*It's Barbeque SEASON!*

Your full-service meat shop, offering an extensive selection of fresh, premium elk and bison products for unparalleled taste and nutrition

- Elk burgers
- Yellowstone burgers (combo)
- Elk & cheese smokies
- Elk garlic sausage
- Bison smokies

**STONWOOD ELK RANCH LTD.**  
STEAKS • ROASTS • GROUND • STEWING & STIR FRY MEAT  
LIVER • SOUP BONES • GARLIC SAUSAGE

**CALL OR TEXT 204-791-9856**  
(by appointment only)

StonewoodElkRanch.com  
stonewoodelkranch@gmail.com

**DIRECTIONS FROM BALMORAL: 1 MILE SOUTH ON HWY 236 & 1.75 MILES EAST ON ROAD 84N**  
**OR 1 MILE SOUTH ON HWY 7 AND 1.25 MILES WEST ON ROAD 84N (Watch for Stonewood Elk Ranch sign)**

**Keep the Jeep**  
**WIN A NEW JEEP SAHARA!**  
SOME CONDITIONS APPLY. DETAILS AT SOUTHBEACHCASINO.CA

**MAY 31ST**

**SOUTH BEACH CASINO & RESORT**  
*Simply Irresistible!*

# Manitoba Coin Club shares rich currency history with rural Manitoba

Spring coin show set for May 31 in Morden with Royal Canadian Mint on site for coin exchange

By Lana Meier

The Manitoba Coin Club is heading back on the road with a renewed mission to promote numismatics in communities across rural Manitoba.

Numismatics — the study and collection of currency, including coins, tokens, paper money and medals — is one of the world’s oldest hobbies. Since 1954, the Manitoba Coin Club has brought collectors together to share in that passion. Over its 70-year history, the club has hosted two national conventions and remains a hub for currency collectors across the province.

“We’re always working to expand interest and awareness, especially

outside Winnipeg,” said Larry Dalman of the Manitoba Coin Club. “Bringing our spring coin shows to rural communities has really helped us connect with a wider audience.”

That rural outreach began in 2023, when the club hosted its first-ever Spring Coin Show outside the city — at the Red Barn in the RM of Rockwood. With strong local promotion, including stories in the *Stonewall Teulon Tribune*, the event drew hundreds of visitors from the Interlake and southern Manitoba.

“People came who had never heard of the club but were already collectors in their own way,” Dalman said. “They brought coins and bills to learn

more about them, to get appraisals, and to buy pieces to build their collections.”

Encouraged by the turnout, the club brought its 2024 Spring Show to Steinbach, again reaching new hobbyists through local media and community interest.

A popular highlight at each show is the Royal Canadian Mint’s coin exchange booth, where attendees can trade cash for five newly minted commemorative coins at face value. Visitors also receive two free passes for a tour of the mint’s Winnipeg facility.

“Having the mint attend our shows adds a huge draw,” Dalman said. “People get a chance to collect brand new coins and see where they’re made.”

This year’s spring coin show will take place in Morden on Saturday, May 31 from 10 a.m. to 4 p.m. at the Morden Access Event Centre (111-D Gilmour St.). The Royal Canadian Mint will be on site for the full event, offering its coin exchange and sharing insight into Canada’s coin-making process.

The outreach comes as the club prepares for a major milestone — hosting the Royal Canadian Numismatic Association’s 2026 Convention and Numismatic Show from July 14 to 19 at the Fairmont Hotel in Winnipeg. That same year, the Winnipeg mint will celebrate its 50th anniversary.

“The mint is a global leader in coin production, making currency for around 80 countries, not just Canada,” said Dalman. “It’s fitting that Winnipeg will host the national show during such a major anniversary.”

Dalman noted that numismatics is more than just collecting — it’s a window into the past.

“Coins and currency tell stories,” he said. “They’ve been used for trade, for propaganda, even as emergency money in wartime.”

In 17th-century New France, for instance, a shortage of coins led officials to issue playing cards marked with monetary values as temporary promissory notes. During the Second World War, resistance forces in Norway smuggled currency plates out



PHOTO SUBMITTED

In 1685, playing cards were used as emergency currency in New France due to a coin shortage — each marked with a denomination and used as a promissory note until more coins arrived from France. These cards and other older coins are still in existence and being sold at Coin Shops and Auction houses in Canada.

of the country so allies could print banknotes to support underground movements. And during the fur trade era, beaver pelts were exchanged for goods, with token systems used by companies like the Hudson’s Bay Company.

“People don’t realize how much history is sitting in their pockets or tucked into a drawer at home,” Dalman said. “Numismatics helps bring that history to life.”

The Manitoba Coin Club continues to welcome new members of all ages. Monthly meetings, educational sessions and public shows offer opportunities to learn, trade and build collections.

“We invite anyone with an interest in coins or currency to stop by the show in Morden,” Dalman said. “It’s a great way to get started or to connect with others who share the same passion.”

# GRAND REOPENING

# WETLAND

# DISCOVERY CENTRE

Newly reimaged interactive exhibits!

# MAY 24, 2025

Plan your visit at [oakhammockmarsh.ca](http://oakhammockmarsh.ca)

Don't forget to send your special wishes to your friends and family.

Call 204-467-5836

# sports & recreation

INSIDE > OUTSIDE > UPSIDE DOWN

## Top talent clashes at Selkirk's Royal Rumble track meet



EXPRESS PHOTOS SUBMITTED

From left: Gimli's Dylan MacLean competed in high jump; Luke Robinson ran in the varsity men's 400m; and Jencie Henry placed first in women's varsity shot put with a massive personal best of 12.41m. Henry also topped the podium in women's varsity discus and the varsity outdoor pentathlon with 688 points — all at the Royal Rumble track and field meet in Selkirk.

## Tigers defeat Chiefs for franchise's sixth WHL title

By Kieran Reimer

An incredible playoff run has come to an end for the Spokane Chiefs and goaltender Dawson Cowan.

On Friday, the Chiefs played what would become the final game of their season, falling 4-2 to the Medicine Hat Tigers in Game 5 of the Western Hockey League Championship.

Cowan, of Warren, Man., got the start in Game 5 at the Spokane Veterans Memorial Arena with the Chiefs entering the best-of-seven series down three games to one.

Neither team found the net until Tigers defenceman Niilopekka Muhonen broke the game open in the second period with a wrister from the point that beat Cowan glove side for his first goal of the playoffs.

Seventeen-year-old Gavin McKenna added to the Tigers' lead early in the third with his ninth of the postseason, followed shortly after by Hunter St. Martin, who made it 3-0.

The Chiefs responded just under a

minute later on the power play, with Andrew Cristall scoring his league-leading 21st goal of the playoffs.

Spokane pulled within one less than three minutes later when Assanali Sarkenov scored to make it 3-2 heading into the back half of the final frame.

Scoring stalled until the final minutes, when Tigers defenceman Bryce Pickford sealed the win with an empty-net goal, as Medicine Hat celebrated the sixth Ed Chynoweth Cup in franchise history.

The Tigers now advance to the 2025 Memorial Cup, taking place May 22 to June 1 in Rimouski, Que.

As for the Chiefs, their remarkable season and playoff run has come to an end.

Cowan, 19, made 32 saves in Game 5, bringing his postseason total to 495 across 19 games. He finishes the playoffs second in goaltender wins after leading the WHL with 34 victories in the regular season.



EXPRESS PHOTO BY BRETT MITCHELL

Fisher Branch's Patrick Yuzwa, a Grade 12 athlete, competed in the varsity men's 800m at the Selkirk Royal Rumble on May 13, 2025, finishing with a time of 2:24.56.

# Gimli Airport playing role in emergency firefighting effort

By Patricia Barrett

The Gimli Airport is playing an important role in the provincial government's firefighting efforts of forest and grass fires in Manitoba.

The airport was running full tilt last week to keep a fleet of Babcock water bombers fuelled for the firefight in eastern Manitoba and other locations.

Gimli Coun. Andy Damm said the airport is always ready to step up to help the province in its firefighting efforts.

"CYGM [Gimli Airport] has been and hopefully will continue to be a base for the strategic deployment of provincial airborne firefighting assets," said Damm, a retired commercial airline pilot who has liaised with the provincial and federal governments on airport matters and was recently appointed to the municipality's newly formed Airport Working Group.

Manitoba's fire season got off to an early start this year with extensive swathes of dry territory left unquenched by snowmelt and too little precipitation, coupled with days of intensely hot temperatures and high winds that aided in the alarming spread of some fires.

A man and a woman died in the RM of Lac du Bonnet last week when they could not evacuate during a raging fire. The RCMP recovered their bodies on May 14.

"The RCMP was made aware on May 13th these individuals were trapped in the fire, however, due to extreme conditions, emergency personnel were not able to reach their location until the following day," said the RCMP in a May 14 news release.

Water bombers fighting the fires last week were temporarily interrupted when someone flew a drone near the fire zone, endangering firefighting crews.

"RCMP would also like to remind people that the area around the fire zone is a restricted air space, and the use of drones is not permitted, as it significantly impedes the work of all air support fighting the fire," said the service.

The human-caused fire near Lac du Bonnet had grown to 4,008 hectares by last Friday (May 17) and was still burning out of control, according to the province's FireView Map. A massive naturally caused fire that's engulfed Nopiming Provincial Park and areas outside the park in eastern Manitoba was also still burning out of control as of last Friday. It had grown to 101,689 hectares. And a human-caused fire north of Selkirk had grown to 5,000 hectares but was "being held."

Manitoba Hydro crews were restoring power to areas affected by the wildfires in the eastern part of the province. The utility was able to "re-energize" about 900 customers along the Lee River on May 14. About 500 remained without power on May 15 in a number of other areas in the wildfire zone.

"Manitoba Hydro crews are now able to safely access some areas with significant fire damage, including burnt and fallen poles, power lines, transformers and other equipment," said Hydro in a May 15 news release. "Construction crews staged in Lac du Bonnet Wednesday night [May 14] and were able to begin work on Wendigo Road as soon as it became accessible today. The extent of damage is still being assessed and may require complex repairs, so it's too soon to provide estimated times of restoration."

The provincial government announced last month it's upgrading its firefighting fleet with an \$80-million investment in three new water bombers, DH Canadair 515 Firefighter aircraft that will be made in Canada.

"Upgrading our fleet with these three new DHC-515 Firefighter water-bombers reflects our commitment to ensure that our front-line firefighters have the tools they need to protect Manitobans," said



EXPRESS PHOTO COURTESY OF THE PROVINCE OF MANITOBA

A fire burns in the RM of Lac du Bonnet last week. Provincial airborne firefighters have been battling the human-caused fire, which had grown to 4,008 hectares by Friday, May 17 and was still burning out of control, according to the province's FireView Map. Provincial water bombers stationed at the Gimli Airport have been helping fight the fire from the sky.

Manitoba Premier Wab Kinew in an April 25 news release. "We're protecting the people of Manitoba along with their communities, property and valued forests from the increasing frequency and severity of wildfires in a manner that aligns with our Canada-first approach by ensuring these aircrafts are made in Canada."

The Gimli Airport is home to four water bombers (CL-415 turbine aircraft), two bird dogs — aircraft that spot fires and help water bombers get into prime attack position — aircraft maintenance personnel and pilots. They play an important role protecting Manitobans, property and the environment.

The RM of Gimli's community engagement manager Christine Payne said the Gimli Airport will continue to provide emergency support services throughout the season.

"Gimli Airport is currently experiencing high operational demand as it supports provincial wildfire suppression efforts. With firefighting aircraft on high alert, fuel consumption has surged — prompting priority resupply efforts to maintain readiness," she said. "While typically not as active, the airport is committed to supporting emergency operations when called upon."

Gimli Airport's manager Brian Renaud ensures the airport "remains operational" through the supply of fuel needed for aircraft and having the communications in place to support the aircraft.

Council approved the creation of the Gimli Airport Working Group at its May 14 meeting. An earlier resolution at council's April 9 meeting had appointed Damm, Renaud and the RM's assistant CAO Kelly Cosgrove to sit on the working group.

They will, among a number of duties, work towards re-negotiating an operating agreement with the provincial government, which owns the airport.

"Once the document [operating agreement with the province] is finalized, the requirement for an AWG will continue although the composition and role may be subject to revision. All decision points during the negotiations and subsequent roles conducted by the RM of Gimli shall be brought to the RM Council prior to commitments being made," states the working group's terms of reference.

The group will also look at matters pertaining to capital investment in the asset, operational responsibilities and associated costs with a view to having a "break-even operating cost with the RM," future staffing levels via RM employees or contracted service providers and future equipment requirements to support and sustain the airport.

The Gimli Airport is considered a "strategic asset from the provincial perspective," according to background material supplied by Payne. And the regional economic spinoffs make it of "critical interest" to the municipality.



FireView Table

## PROVINCE OF MANITOBA FIREVIEW

Two fires (in red) burning out of control last week in the RM of Lac du Bonnet and Nopiming Provincial Park. A human-caused fire north of Selkirk (in yellow) had grown to 5,000 hectares but was "being held."

# Classifieds

THE EXPRESS  
WEEKLY NEWS

## SCRAP METAL

BUYING SCRAP METAL, CARS, TRACTORS, COMBINES, FARM SCRAP, ANY METAL MATERIAL, ANY FARM MACHINERY. PH LONNIE AT 204-886-3407 LVE. MESSAGE OR CELL AT 204-861-2031.

Buyer for all farmyard scrap, machinery and autos. No item too large! Best prices paid, cash in hand. Phone Alf at 204-461-1649.

## MACHINERY

New Holland square baler 273 Hayliner; New Holland Hay Stackliner 55 bale capacity, good condition (new cable, new release springs). Inquire call 1-204-861-0126.

## LIVESTOCK

Red Angus yearling bull, birth weight 88 lbs., recommended for cows. Delivery available. For more info. call 1-204-861-0126.

## LIVESTOCK

Rawcliffe Grange Stock Farm, Rosser, MB. has polled Hereford bulls for sale. Docile, calving ease bulls that are semen tested and guaranteed. Free delivery. Call Jim at 204-461-0884.

## SEED

Certified #1 Algonquin alfalfa seed for sale. Inoculated, 50 lb. bags. Carla Shergold 204-298-4099.

THE EXPRESS  
WEEKLY NEWS  
204-467-5836

## APARTMENT FOR RENT

1 bdrm. suites available in Teulon - \$898 monthly. Farview Place is seeking new 55+ Seniors for our independent living cooperative housing apartment building. Suites are spacious and includes Valley Fiber Phone, Internet & TV, hydro and water. Our building is 5 storeys and has an elevator, paid parking, 4 laundry rooms, exercise room, lounge for family gatherings and events, fridge & stove in each suite. Local amenities include grocery store, post office, Shoppers Drug Mart, Access Credit Union, medical clinic, several restaurants & small shops. Please contact Andrea at 204-886-2760 or farviewplace1989@gmail.com for more information.

## SEED

FORAGE SEED FOR SALE: Organic & conventional: Sweet Clover, Alfalfa, Red Clover, Smooth Brome, Meadow Brome, Crested Wheatgrass, Timothy, etc. Star City, SK. Birch Rose Acres Ltd. 306-921-9942.

## ACCOMMODATIONS/ CAMPING

Seasonal and daily campsites available for rent at Narrows Sunset Lodge. Services: rooms, cottages, fishing, convenience store, beer/liquor, restaurant. Phone Irv 204-768-2749 or 204-981-2831

## PROPERTY FOR SALE

Nice 20-acre retirement or subdividing opportunity 4 miles west of Brandon on paved road. 1,572 sq. ft. home including appliances, wheelchair accessible, 1-level, attached garage. Also, additional adjoining subdivided 5-acre lot. Immediate possession, private sale. \$750,000. Call 1-204-723-0083 for appointment to view, anytime.

**News Tips?**  
call the Express  
204-467-5836

## WATER TREATMENT

Pentair softeners. Iron removers. Reverse osmosis systems \$298. All sizes water housings and filters. Well-rite 20 gallon pressure tank \$295. Res Care softener cleaner \$29. All Seasons 204-661-8581.

## WANTED

WANTED: buying estates, contents of homes, farms, barns, sheds, garages, etc. Buying most anything old & interesting! TEXT/PHONE: 204-918-1607. Junkies Estate, Salvage, Antiques & Oddities.



## GROUND EXCAVATION TENDER:

**Owner: Interlake Coop**

**Location: 16 Railway Ave, Eriksdale, Mb**

### Summary of project:

- Ground excavation of 16 Railway Ave
- Remove soil layers
- Backfill with coarse rock, fines, clay, gradient work, etc. to repel water and effectively drain into town drainage located on adjacent lot to the south, (survey results available upon request)
- Complete required drainage around perimeter of lot to ensure acceptable drainage to town drainage point, along with preventing any damage risk to neighbouring buildings
- Complete drainage of sump pit on 18 Railway Ave
- Adequate fill and ground preparation to allow for forklift and freight access without damage to ground
- Please indicate in tender earliest start date
- Further details on starting/ending dates can be discussed at the contact information below
- Awarded contractor to provide and maintain a comprehensive general liability policy in a minimum of \$2,000,000.00 all inclusive.
- Lowest bid not necessarily accepted

### Questions/Tenders can be submitted to:

Tori Goodman (Eriksdale Branch Manager) by May 30, 2025, 12 noon.  
tori.goodman@interlake.crs, 204-739-2634

**News Tips? call the Express 204-467-5836**

## EASTERN INTERLAKE PLANNING DISTRICT

UNDER THE AUTHORITY OF THE PLANNING ACT

# NOTICE OF PUBLIC HEARING

On the date and at the time and location shown below, a PUBLIC HEARING will be held to receive representations from any person(s) who wish to make them in respect to the following matter:

THE EASTERN INTERLAKE PLANNING DISTRICT BY-LAW NO. 02-2025  
Being an amendment to the Eastern Interlake Planning District's Development Plan By-law No. 01-2022

**HEARING LOCATION:** Municipality of Bifrost-Riverton  
Council Chambers  
329 River Road, Arborg MB

**DATE & TIME:** June 5, 2025  
5:00 pm

**APPLICATION:** MBR-25-01A

**AREA AFFECTED:** Pt. RL 22-22-2EPM, Being  
Pt. Lot 2, Plan 15257 WLTO  
11032 River Road, Roll 48200

**GENERAL INTENT:** To re-designate an area in the Municipality of Bifrost-Riverton from "Agriculture Rural - Limited Area" to "Commercial General Area" to accommodate an existing business and future development.

**CONTACT FOR INFORMATION:** Nancy Thom, CAO/Development Officer  
Eastern Interlake Planning District  
62 2<sup>nd</sup> Avenue, P.O. Box 1758, Gimli, MB R0C 1B0  
Phone: 204-642-5478 Fax: 204-642-4061  
E-mail: [eipd@mymts.net](mailto:eipd@mymts.net) Web: [www.interlakeplanning.com](http://www.interlakeplanning.com)



A copy of the circulation package may be provided/inspected at the location noted above during normal office hours, Monday to Friday; alternatively, a copy may be emailed upon request.  
Please note, if you have received this notice in the mail, it includes the circulation package.

**Please Note: E.I.P.D. recommends that property owner's notify lessee/renter if applicable.**

## MUNICIPALITY OF BIFROST-RIVERTON

UNDER THE AUTHORITY OF THE PLANNING ACT

# NOTICE OF PUBLIC HEARING

On the date and at the time and location shown below, a PUBLIC HEARING will be held to receive representations from any person(s) who wish to make them in respect to the following matter(s):

THE MUNICIPALITY OF BIFROST-RIVERTON BY-LAW NO. 05-2025  
Being an amendment to the Municipality of Bifrost-Riverton Zoning By-law No. 04-2024, as amended.

**HEARING LOCATION:** Municipality of Bifrost-Riverton  
Council Chambers  
329 River Road, Arborg, MB

**DATE & TIME:** June 12, 2025  
9:00 am

**APPLICATION:** RMB-25-02R

**AFFECTED AREA:** Pt. RL 46/47-22-2 EPM  
Roll 55806

**GENERAL INTENT:** To rezone an area in the Municipality of Bifrost-Riverton from "AL" Agricultural Limited Zone to "CH" Commercial Highway Zone, to accommodate a future subdivision and development.

**FOR INFO CONTACT:** Nancy Thom, CAO/Development Officer  
Eastern Interlake Planning District  
62 - 2<sup>nd</sup> Avenue PO Box 1758 Gimli, MB R0C 1B0  
Ph: 204-642-5478 Fax: 204-642-4061  
Email: [eipd@mymts.net](mailto:eipd@mymts.net) Website: [www.interlakeplanning.com](http://www.interlakeplanning.com)

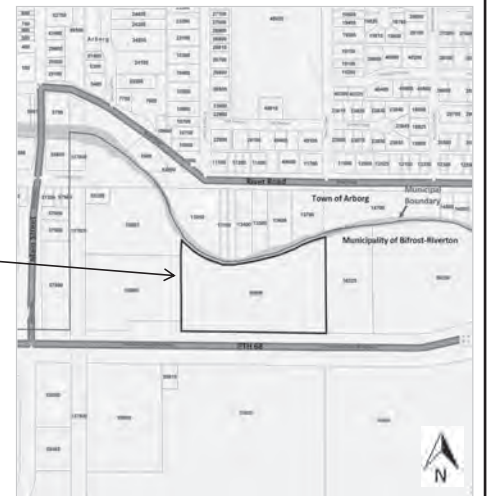

A copy of the circulation package may be provided/inspected at the location noted above during normal office hours, Monday to Friday; alternatively, a copy may be emailed upon request.  
Please note, if you have received this notice in the mail, it includes the circulation package.

**Please Note: E.I.P.D. recommends that property owner's notify lessee/renter if applicable.**



**GLENKO ENTERPRISES (1994) LTD.**  
Box 1000, Arborg, MB R0C 0A0 Phone 376-2340 - 376-5115  
Fax (204) 376-5676 glenکو@mts.net

**Now Hiring!!**  
**Class 1 Licensed Drivers - Road Spreading**  
**Class 3 Drivers - Concrete Mix Trucks**  
**Cone Crusher Operator**  
**Loader Operator**  
**Heavy Duty Diesel Mechanic**

We are accepting applications for qualified individuals for the above positions.

**Position Requirements:**  
~ Valid driver's license  
~ Strong attention to detail  
~ Able to follow direction and work with minimal supervision  
~ Ability to work effectively as a team  
~ Demonstrated reliable attitude, honesty, and integrity  
~ Experience an asset

Great Benefit Pkg Available!

Please e-mail your resume to [glenکو1994ltd@gmail.com](mailto:glenکو1994ltd@gmail.com)  
Attention: Don  
Or mail resume to Glenko Enterprises (1994) Ltd.  
Box 1000 Arborg, MB R0C 0A0



**MUNICIPALITY OF BIFROST-RIVERTON**  
**NOTICE OF BY-ELECTION**

Notice is hereby given that a vote of **WARD 1 - MUNICIPALITY OF BIFROST-RIVERTON** will be taken to elect **COUNCILLOR** from the following duly nominated candidates:

1. BRANDT, LARRY
2. JOHNSTON, KIRK

**VOTING PLACES**

Voting places will be open for voting on **WEDNESDAY the 18TH day of JUNE 2025** between 8:00 a.m. and 8:00 p.m. at **RIVERTON CURLING CLUB, 175 Reggie Leach Dr., Riverton.**

**IDENTIFICATION MAY BE REQUIRED BEFORE BEING ALLOWED TO VOTE.** A person may be required to produce one piece of government issued photo identification (for example - driver's license or passport) or at least two other documents that provide proof of identity.

**ADVANCE VOTING**

For the purpose of accommodating persons who are qualified to vote, but who have reason to believe that they will be absent or otherwise unable to attend their proper voting place on election day, an advance voting opportunity will be located at **RIVERTON CURLING CLUB, 175 Reggie Leach Dr., Riverton** and will be open during the following day: **SATURDAY, JUNE 7, 2025** between 8:00 a.m. and 8:00 p.m.

**APPLICATION TO VOTE BY SEALED ENVELOPE**

A voter who is unable to go in person to the voting place or vote in advance, may apply in person, in writing, or by email to the senior election official at 329 River Rd, Box 70, Arborg MB R0C 0A0 or [janlar5001@gmail.com](mailto:janlar5001@gmail.com).

If applying in person\*, a voter may apply between June 2, 2025 and June 13, 2025.  
\*A voter applying in person may pick up a sealed envelope ballot package at the time of application.

If applying by mail or email\*\*, a voter may apply between May 23, 2025 and June 13, 2025.  
\*\* A voter applying by mail or email will receive a sealed envelope ballot package by regular post, or by making alternative arrangements with the senior election official.

Jan Larkin, SEO  
Municipality of Bifrost-Riverton  
204-641-0329

**WANTED**  
Firearms wanted. Looking for all unwanted firearms. Fully licensed for both non-restricted and restricted. Anywhere from individual items to estates. Cash buyer, paying top dollar. Please call or text Adam at 204-795-2850.

**UPCOMING EVENTS**  
JOIN THE FIGHT AGAINST PROSTATE CANCER! The Motorcycle Ride for Dad is Saturday, May 31 2025, 10 AM, Polo Park, Winnipeg. Visit [ridefordad.ca/](http://ridefordad.ca/) Manitoba to register or make a pledge.

**NOTICES**  
URGENT PRESS RELEASES - Have a newsworthy item to announce? An exciting change in operations? Though we cannot guarantee publication, MCNA will get the information into the right hands for ONLY \$35 + GST/HST. Call MCNA (204) 947-1691 for more information. See [www.mcna.com](http://www.mcna.com) under the "Types of Advertising" tab for more details.

**FINANCIAL SERVICES**  
Private mortgage lender. All real estate types considered. No credit checks done. Deal direct with lender and get quick approval. Toll free 1-866-405-1228 [www.firstandsecondmortgages.ca](http://www.firstandsecondmortgages.ca)

**EMPLOYMENT OPPORTUNITIES**

**Kletke Seed Farm Ltd** is hiring for a Production Coordinator (office position). Forward resume to [info@kletkesseedfarm.com](mailto:info@kletkesseedfarm.com) 204-886-2822 11080 E Road 91N, Teulon, MB [Kletkesseeds.com](http://Kletkesseeds.com)



**NOTICES**  
NEED CLASS 1 DRIVERS? HIRING? SELLING SOMETHING? Jump on our great prices and start getting responses! Book your blanket classified ads, seen in the 31 Member Newspapers which are seen in over 368,000+ homes in Manitoba. Please call 204-467-5836 or MCNA at 204-947-1691 for more details or to book ads. -MCNA - Manitoba Community Newspapers Association. [www.mcna.com](http://www.mcna.com)

**News Tips?**  
call the Express 204-467-5836

**NOTICE TO CREDITORS**  
IN THE MATTER OF THE ESTATE OF: LISA GAIL BAKER, late of the R.M of Gimli, in Manitoba, Deceased. ALL claims against the above estate, duly verified by Statutory Declaration, must be filed with the undersigned at their offices, 72A Centre Street, P.O. Box 6500, Gimli, Manitoba, R0C 1B0, on or before the 19th day of June, 2025. DATED at Gimli, Manitoba, this 22nd day of May, 2025. BAKER LAW CORPORATION SOLICITORS FOR THE EXECUTORS Attention: Grant D. Baker

**HEALTH**  
Are you suffering from joint or arthritic pain? If so, you owe it to yourself to try elk velvet antler capsules. Hundreds have found relief. Benefits humans and pets. EVA is composed of proteins, amino acids, minerals, lipids and water. Key compounds that work to stimulate red blood cell production & cartilage cell regeneration & development. Stonewood Elk Ranch Ltd., 204-467-8884 or e-mail [stonewoodelkranch@mymts.net](mailto:stonewoodelkranch@mymts.net)

Eddie's Gravel Supply Ltd. is Hiring

**CONCRETE FINISHERS FULL TIME**

**EXPERIENCE REQUIRED**  
Winnipeg Beach, 204-389-2023  
[info@eddiessgravel.com](mailto:info@eddiessgravel.com)

**Online McSherry Auctions**  
Firearms, Ammo & Accessories  
May 27<sup>th</sup> @ 7:00 PM  
Estate & Moving  
May 28<sup>th</sup> @ 7:00 PM  
Estate & Moving  
June 4<sup>th</sup> @ 7:00 PM  
12 Patterson Dr.  
Stonewall, MB  
204-467-1858 or  
204-886-7027  
[McSherryAuction.com](http://McSherryAuction.com)

**WANTED**  
COIN COLLECTIONS & OLD JEWELRY!  
CASH for Unwanted Jewelry, Accumulations & Collections of Coins, Numismatics, Royal Canadian Mint Coins, Franklin Mint, US & CAN. SILVER DOLLARS, Old Rolls, Bags & Boxes of Coins, Silver Coins, Gold Coins, Old paper \$\$\$, Bullion, Jewelry, Nuggets, Sterling Silver & ALL Silver & Gold items!  
COVERING ALL OF MBI!  
Todd  
204-904-9705

**MAINTENANCE PERSON Required**  
3-4 months of work.  
Fishing Lodge.  
Carpentry, metal roofing, levelling cabins, etc.

**Please contact 1-204-937-4007**  
**BATTERIES FOR EVERYTHING! 50,000 BATTERIES IN STOCK**  
\*Auto \*Farm \*Truck  
\*Construction \*ATV  
\*Motorcycle \*Golf Carts  
\*Rechargeables \*Tools  
\*Computers \*Medical  
\*All phones \*Chargers  
\*Marine \*RV & more  
Shipping/Delivery avail.  
**THE BATTERY MAN**  
1390 St. James St.  
Winnipeg  
**TF 1-877-775-8271**  
[www.batteryman.ca](http://www.batteryman.ca)



**WE ARE HIRING**

Romafa Metal Works, Inc, a growing, internationally-operated enterprise in the Interlake region of Manitoba is looking for a skillful, well-educated, and experienced product developer in the mechanical engineering field with programming skills.

As a product developer the employee will be part of a small mechanical engineering team and responsible mainly for modelling, drafting, and making installation manuals for stainless-steel products in cooperation with production, sales and marketing department by using CAD and making required calculation by means of SolidWorks and Excel.

**The profile:**

- A well-experienced product developer in mechanical engineering with a strong SolidWorks knowledge.
- Vocational training and practical experience in mechanical aspects are urgently needed.
- A bachelor degree of a Canadian university or recognized comparable education in mechanical or electro-mechanical engineering would be appreciated.
- Experience in agricultural and / or food processing machinery industry is required.
- Profound knowledge and experience in industrial steel and stainless-steel processing is required.
- Familiarity with European mechanical engineering standards would be very much appreciated.
- Willingness and ability to go along with existing design and production process standards and still having a strategy and constructive suggestions on how to improve and optimize the process step by step.
- As SolidWorks includes an application programming interface, you should be experienced to use it in order to optimize the design and production process.
- Some knowledge in CNC programming would be considered as a plus.
- ERP-system experience would be very useful.
- The average level of English at least IELTS 6.

**Other information**  
Location of work: Mainly in Arborg.  
To apply, send application and resume: Email: [ronald@romafa.com](mailto:ronald@romafa.com)  
Box 4258, Arborg MB R0C0A0

## BRIDAL SHOWER



You're invited to a come-and-go Bridal Shower  
in honour of Amber Gulay  
bride-elect of Delwyn Doerksen.  
Saturday, June 7th, 2025  
1:00 p.m. - 3:00 p.m.  
at the Arborg Heritage Hall  
Donations can be dropped off at  
Arborg Home Hardware and Co-op.  
Amber is registered at Arborg Home  
Hardware,  
Canadian Tire and on Amazon.  
We look forward to celebrating with you!

# Classifieds Announcements



Book Your Classified Ad Today - Call 467-5836 or  
Email ads@expressweeklynews.ca

## IN MEMORIAM

Anne Chudd  
May 27, 2005

May the winds of love blow softly,  
And whisper so you can hear;  
We will always love and miss you,  
And wish that you were here.  
Your daughter is now with you,  
you are both lovingly remembered by  
your son-in-law David  
and grandsons Jon and Eric

## Registered Purebred Polled 2 Year Old and Yearling CHAROLAIS BULLS FOR SALE

We have a good selection of quality bulls.  
Will be semen tested. Delivery & EPD's available.

For more information call  
Ken at (204) 376-2418 (land line)  
or Text to (204) 641-3788  
KLCC Charolais, Arborg

## OBITUARY

Alma Broustal (nee Gutknecht)  
May 18, 1939 - May 17, 2025

Peacefully on May 17, 2025 at the Lakeshore General Hospital in Ashern, MB, Alma Broustal, aged 85 years, passed away with family at her side.

A funeral service will be held at 2:00 p.m. on Tuesday, May 27, 2025 in the Ashern Centennial Hall. Interment will be held in the Ashern Holy Cross Cemetery with a luncheon to follow in the hall.

In lieu of flowers, donations may be made in Alma's memory to the Lakeshore Hospital Guild, PO Box 1, Ashern, MB R0C 0E0.

Arrangements by:  
ARNASON FUNERAL HOME  
Ashern - Lundar  
1.204.768.2072  
1.866.323.3593

## OBITUARY

Preston Scott Horvath  
July 30, 1979 - May 3, 2025

With profound sadness, we announce the sudden passing of our beloved son, brother, uncle, grandson Preston Horvath at the Grace Hospital.

He will be lovingly remembered and deeply missed by family and friends, mother Sandra Lobban, stepfather David Lobban, sister Gina (Todd), niece Madisson (Jack), nephew Logan, extended family Ian Lobban (Carrie), Scott Lobban (Katherine) and Kelly and many family members West and East in this great country.

Predeceased by grandparents Margit and John Horvath and grandmother Shirley Fedyk (May 2, 2025 - 12 hours earlier).

Thank you to the staff at the Grace Hospital for taking such good care of Preston on more than one occasion.

A service will be held Saturday, May 31, 2025 at 3:00 p.m. at St. Bartholomew Church, 291 Churchill Road, Winnipeg Beach, Manitoba.

Donations can be made to Balance & Dizziness Canada (Meniere's Disease) at:  
<http://balanceanddizziness.org/donate/leaving-a-legacy/>

Friends and family are invited to visit Preston's memorial page at [www.interlakecremation.ca](http://www.interlakecremation.ca), where memories and condolences may be shared.

Arrangements entrusted to:

Interlake Cremation  
& Memorial Services  
204.482.1040

# take a break

> GAME

## SUDOKU

4		9				3		
7								2
		3		8		7		
9					5	6	3	1
								9
8	3					5		7
1				9				3
	4				6		2	5
		2		4				

Level: Intermediate

## Fun By The Numbers

Like puzzles?  
Then you'll love  
sudoku. This  
mind-bending  
puzzle will have  
you hooked from  
the moment you  
square off, so  
sharpen your  
pencil and put  
your sudoku  
savvy to the test!

## Here's How It Works:

Sudoku puzzles are formatted as a 9x9 grid, broken down into nine 3x3 boxes. To solve a sudoku, the numbers 1 through 9 must fill each row, column and box. Each number can appear only once in each row, column and box. You can figure out the order in which the numbers will appear by using the numeric clues already provided in the boxes. The more numbers you name, the easier it gets to solve the puzzle!

## SUMMER STUDENT Employment Opportunity

### Recreation Assistant 32 hrs/week July 2 - Aug. 29, 2025

Riverdale Place Homes Inc. provides support to adults living with an intellectual disability in the community. We are looking for a summer student to assist with recreational programming for individuals living in our group homes and independently in the community.

The successful candidate will be mature, creative, outgoing and energetic, willing to take on a variety of tasks. If you are interested in learning more about the work we do, and getting to know the exceptional people we support, this might just be the perfect summer job opportunity for you.

CPR & First Aid training provided, valid driver's license required.

Please apply in writing to:  
Executive Director  
Riverdale Place Homes Inc,  
Box 968, Arborg MB R0C 0A0

Or email: [kfinnson@riverdaleplacehomes.com](mailto:kfinnson@riverdaleplacehomes.com)

**Application Deadline: June 3, 2025**

For more info contact:  
Kathy Finnson, ED 204-376-2940, ext. 2

## Everything you need to promote your business



Call Today!  
467-5836

For all your printing  
and publishing needs

## Full-time Employment Opportunities

In Arborg at busy  
implement dealership



Shachtays in Arborg is hiring additional  
staff for the following positions:

- **Service Technician**
- **Parts/Counter Person**

Experience not necessary but a  
definite asset. Benefit plan available.

Apply in person, fax, mail or  
e-mail resume to: 276 Ardal St.,  
Box 190, Arborg, MB R0C 0A0  
[shachtays@hotmail.com](mailto:shachtays@hotmail.com)

Ph: (204) 376-5233

Fax: (204) 376-5234

Locally owned and operated.  
Serving the Interlake for 59 years.



# Announcements



Book Your Classified Ad Today - Call 467-5836

## OBITUARY



### Viola Christine Johnson

Our beloved Aunt, Viola Christine Johnson, died peacefully at age 90 on April 30, 2025, surrounded by family.

She was predeceased by her parents, Laufey and Jonas Johnson, and siblings George, Daniel, and Gloria.

Viola attended Daniel McIntyre Collegiate and the University of Manitoba. After touring Europe, she joined Great West Life as a mortgage analyst, where her kindness, humour, and strong work ethic defined her 30-year career. An ardent feminist, she believed deeply in equality and financial independence for women.

Like most Icelanders, Viola delighted in discussing genealogy – past and present – almost as much as she loved reading.

She is survived by many nieces and nephews, all of whom cherished her deeply. Her bold, intricate, and beautifully made quilts adorn their beds and walls around the world, linking the

generations.

A family gathering will be held in Gimli this summer to celebrate Vi with stories.

Special thanks to the caring staff at Grace Hospital, the MAID team, and Thorvaldson's Care Centre - particularly Jocelyn and Karen.



204-949-2200  
Gimli 204-642-7124  
neilbardalinc.com

## OBITUARY

### Maureen Elenor Pedersen (nee Parkinson) November 8, 1935 - May 7, 2025

It is with sadness and loss in our hearts, we announce the sudden loss of our beloved mother and grandmother, Maureen Pedersen (nee Parkinson).

She is predeceased by our father and love of her life Henry Pedersen who passed July 3rd, 2002;

her mother and father George and Dorothy Parkinson; mother-in-law Johanna Christine Pedersen; brother-in-law and sister-in-law Anker and Lorraine Pedersen; brother-in-law Raymond Gluchi; grandson Jesse Pedersen and his daughter Hope along with numerous friends and loved ones whom touched her heart.

She is survived and loved deeply by her four children, Jeffery Pedersen (Ruby), Kelli Barnett (Ted), Shane Pedersen and daughter-in-law Jacque and Leah Pedersen; sister Janis Matthews and brother David Parkinson.

She will be missed so much as a mother and grandmother to Breanne, Brenna, Dana, Ashley, Vanessa, Jorden, Tyson, Daniel and Matthew as well as numerous great-grandchildren and another due in June.

Maureen dedicated her life as a loving wife, and raising their children thru the years "Tuffy" was away working and many years of sickness and health issues. She loved cooking and baking for our family occasions, visits, and her friends and company in Sandy Hook, MB where she had built the beautiful home she loved so much.

Sadly, Mom got very sick just over three years ago and although she pulled thru, she developed dementia and moved into Springfield Seniors Complex in Oakbank, MB. The family expresses sincere gratitude to the staff for the great care and comfort she received. A special thank you to Clare Reimer for working so closely with Kelli to make the best for her.

She had a full lifetime and went peacefully in her sleep on Wednesday, May 7, 2025 just as she had always hoped for! There were many special friends throughout the years that touched her heart and she loved all the company and times spent in her home. Thank you to all!

The family will be having a special celebration of life at a later date and there will be no official service. Mom almost made it to Mother's Day when all of her children were home. We did get to visit and spend some time with her saying goodbyes, listening to music she loved, sharing stories and laughing and crying before her cremation. Thank you so much to Gilbert Funeral Home for exceptional support and last minute arrangements. We are grateful you made this Mother's Day happen for us and all your expertise and care you've given to us!

Another Star in the Sky!!

Rest Well

Love your Family

Tributes: [www.gilbartfuneralhome.com](http://www.gilbartfuneralhome.com)

Gilbart Funeral Home, Selkirk in care of arrangements.



## SERVING YOUR COMMUNITY

- Monuments
- Restoration
- Granite
- Pillow markers
- Level monuments
- Bronze
- Pre Needs
- Renew monuments
- Columbariums
- Final Dates
- Engraving
- -single, family, community

Appointments available in the comfort of your home

Email: [sunsetmemorialsgimli@gmail.com](mailto:sunsetmemorialsgimli@gmail.com)  
[www.sunsetmemorialsgimli.ca](http://www.sunsetmemorialsgimli.ca)

Bus: 1-204-642-8818  
Cell: 1-204-407-3096

## OBITUARY



### Wilma Elizabeth Palmer (Cusitar)

Wilma Elizabeth Palmer (Cusitar), Willie to her childhood friends, age 84, died on September 18, 2024 at Dulcina Hospice in NW Calgary. She was diagnosed with stage four cancer in February 2024 and her friends and family used her remaining time to show her how much she was loved.

Wilma was born in Russell, MB on December 29, 1939, joining sister Aleta Pulver (Cusitar) to parents Clifford and Annie (Noble) Cusitar. She grew up to be a strong, independent woman who navigated a real estate career and raised a family with then husband Clifford Palmer. She made the work/home life balance look easy even when it was not. She used to say God grant me patience, but please hurry! She always made time for family, friends, co-workers, and clients. Her clients admired her integrity and honesty. Her friends and family loved her raucous laugh,

loving embraces, and spirited opinions. You always knew where you stood with Wilma, she didn't play mind games. But she did love to play games. Curling and cards especially. She was a fierce sports lover and gave epic Grey Cup parties as she loved to entertain friends with food and fellowship. She was a huge fan of the Winnipeg Blue Bombers and the Winnipeg Jets, and she followed the Canadian curlers.

Some of Wilma's fondest retirement days were living in a home she purchased in Matlock, Manitoba with two buildings. The first was a guest house she called, "The Hoot and Holler," because as you might guess, it was only a hoot and holler from her house. And the second was the garage which she called, "The Crape Shop." For six years, she was a snowbird for six months at daughter Carmen Oliver (Palmer) and son-in-law Doug Oliver's (grandkids - Cassidy Brooke, Halle Breanne, and Wyatt Douglas) home in Round Rock, TX. Nana was an integral part of the family. She would help with carpooling, attend soccer games, and often made her infamous "Nana's chili." To this day, her bedroom is still called "Nana's room."

With her retirement years turning to the golden years, Wilma moved from Matlock to Airdrie where she could be a hoot and a holler away from her son Ryan Palmer and daughter-in-law Margaret Palmer (Monk) (grandkids - Kennedy Grace and Makenna Brynn). Now there was more time for family dinners, watching her granddaughters excel in swimming and Taekwondo, playing card games together, and calling the bingo at Luxstone Manor where she lived.

Wilma was a faithful Christian, helping her children to build a relationship with the Lord, Bible verse, Ephesians 4:32 -- "And be kind and compassionate to one another, forgiving one another, just as God also forgave you in Christ."

Please join us in celebrating her life on Saturday, May 24th, 2025 with a church service at 1:00 p.m. at the Winnipeg Beach United Church. A luncheon reception will follow at the Winnipeg Beach Legion.

In lieu of flowers, donations can be made to either Dulcina Hospice, 110 Evanspark Manor, NW Calgary, AB (587) 230-5500 or the Kiwanis Club of Gimli & District, P.O. Box 1368, Gimli, Manitoba R0C 1B0, (204) 642-8616. Feel free to mention Wilma in any donation you make as I am sure that will touch their hearts. They were very fond of Mum. The Dulcina staff were true angels with mum's care and the work they do is full of grace, care, and compassion. At Dulcina, they will gladly accept any donation – even bird seed for the resident birds, bunnies, and fowl, which mum loved to watch. As well, mum spent many years working with the Kiwanis Club and even spent a year as their president, and they would be most appreciative of any donation to their worthy organization.

Friends may visit [www.braendlebrucefs.ca](http://www.braendlebrucefs.ca) to leave messages of condolence for the family.

Braendle-Bruce Funeral Service  
Russell, Manitoba is in care of arrangements  
(204) 773-2747

## OFFICIAL NOTICE TO CONTROL NOXIOUS WEEDS INTERLAKE WEED CONTROL DISTRICT

Rural Municipalities of Armstrong, Bifrost-Riverton, Fisher, and Gimli,  
the Town of Arborg, and the LUD of Fisher Branch

Notice is hereby given by the Interlake Weed Control Board that, under the terms of the Noxious Weeds Act for Manitoba, it is the responsibility of the property owner, agent, or occupant to destroy or control noxious weeds.

This is the **OFFICIAL NOTICE** for 2025, to destroy or control as specified within Section 3(1), all noxious weeds as often as necessary to prevent the growth, scattering, and ripening of weeds or weed seeds in the Rural Municipalities of Armstrong, Bifrost-Riverton, Fisher, and Gimli, the Town of Arborg, and the LUD of Fisher Branch.

If the weeds are not destroyed or controlled as required, a representative of the Weed Control Board may enter the land and destroy or control the weeds. The cost of weed control as well as an administration fee will be charged to the property owner through the tax rolls.

The Weed Supervisor will make systematic inspections and will enforce weed control. He is available for general advice concerning control methods and herbicide use.

Specific information may be obtained by contacting the Weed Supervisor, Fred Paulson, at the Arborg Provincial Building, phone 204 376 3313.

Gordon Klym, Chairman  
Interlake Weed Control Board

*The Cooperation of All Citizens is Requested.*

8	7	1	8	4	9	2	6	9
9	2	6	9	1	7	8	4	8
8	9	4	8	6	2	9	7	1
7	4	9	2	9	6	1	8	8
6	8	2	1	8	4	7	9	9
1	8	9	9	7	8	4	2	6
4	1	7	6	8	9	8	9	2
2	6	8	4	9	8	9	1	7
9	9	8	7	2	1	6	8	4

Sudoku Answer

## FOR EVERYTHING YOU NEED TO PROMOTE YOUR BUSINESS...

**FLYERS**      **WINDOW DECALS**      **ENVELOPES**      **MEMO PADS**  
**BROCHURES**      **SOCIAL TICKETS**      **INVOICES**      **POST CARDS**  
**BUSINESS CARDS**      **DOOR HANGERS**      **ESTIMATE SHEETS**      **PRESENTATION**  
**STICKERS**      **LETTERHEAD**      **POSTERS**      **FOLDERS**



**Call Today 204-467-5836**



Get The Job Done!

**Biz Cards**

**To Book A Biz Card Call 204-467-5836**

**GRASS-FINISHED BEEF**  
 Scott and Jenny Beaton      Balmoral, MB  
  
 Jackfishcreekfarm.com  
 jackfishcreekfarm@gmail.com

**SHERLOCK TREE REMOVAL**  
 Pruning • Stump Grinding • Chipper  
 Licensed Arborists  
 Fully Insured - Claim Free  
 30 years Experience  
  
 Vince 861-0487  
 Darren 861-0028

**GOETZ SIDING**  
 • 5" Eavestrough • Soffit/Fascia  
 • Custom Cladding  
 (204)223-7740 goetzsiding@gmail.com

**KINGS AUTOAIR**  
 AUTOMOTIVE AIR CONDITIONING SPECIALIST  
 • Car • Light • Heavy Truck • RV •  
 Red Seal Technician      204-390-2790  
 www.kingsautoair.com      kingsautoair@gmail.com

**Innovative Electric**  
 Ph: 204-641-5266  
 Url: www.innovativeelectric-mb.ca  
 Email: matthew@innovativeelectric-mb.ca

**CONVENIENCE**  
 Grocery • Drinks • Snacks  
 • Coffee to Go • Ice • Firewood  
 • Fireworks • ATM • Greeting Cards  
 • Newspapers • Books • Pet Food  
 • Toys & more  
**SNACKS** • LOTTO  
 20088 First Ave,  
 Sandy Hook  
**OPEN YEAR ROUND** 10AM - 6PM  
 7 DAYS A WEEK

**PharmaChoice**  
 You have QUESTIONS, We have ANSWERS!  
 • Prescriptions • Liquor Store  
 • Home Health Care Aids  
 • Snacks and more!  
  
**LUNDAR PHARMACY** 204-762-5431  
 18 Main St., Lundar

**"From rust to riches, your scrap could be treasure with our unbeatable prices!"**  
 Purchasers of ferrous/non-ferrous materials  
**Call Today**  
  
 Unit 5, 325 Parkdale Rd,  
 St. Andrews MB  
 info@eco-metallics.ca  
 Office:  
 (204) 404-4747

**BNS EXCAVATING**  
 • Design Services • Soil Analysis • Well & Septic Repairs  
 • Frozen Lines • Driveways • Culverts • Trenching  
 • Auger Drilling • Ice Dam Steaming • Septic Fields  
 Residential, Commercial & Industrial  
 Member of Manitoba Onsite Wastewater Management Assoc  
 BNSexcavating@hotmail.com      (204)461-2856

**Bison Piling & Excavation**  
  
 • Helical Piles  
 • Excavation  
 • Skid Steer Services  
**Call 204-461-4443**

**NEW VALLEY ROOFING & RENOVATIONS**  
 Serving The Interlake  
**Henry Reimer**      204-642-2551  
 BP & IKO Certified Roofer      henry.reimer@newvalleyroofing.com  
 newvalleyroofing.com

**Pine View Spray Foam**  
 • Residential and Commercial  
 Spray Foam Insulation  
 info@pineviewsprayfoam.ca  
 (204) 930-3715  
 www.pineviewsprayfoam.ca  
 139092 Hwy. 326, Arborg, MB  
  
 EFFICIENCY MANITOBA REGISTERED SUPPLIER  
 REBATES AVAILABLE FROM EFFICIENCY MANITOBA

**KRIS CUSTOM RENOS**  
 ROOFING & RENOVATION SPECIALIST  
 (204) 302 0009  
 Box 20 - Steep Rock, Manitoba - R0C 2Y0  
 Krismichaluk@hotmail.ca  
 Serving the Interlake for over 15 years

**ALICE ROOFING LTD.**  
 Complete Roofing Service  
 • Residential  
 • Agricultural  
 Licensed & Insured  
 www.aliceroofing.ca      204-757-9092

**BIN RENTALS**  
 Construction or Renovation Projects  
**Call us! 204.389.2023**  
**LOCAL SUPPLIER**

Everything you need to promote your business  
  
 For all your printing and publishing needs  
**Call 204-467-5836**

**SECURE FENCED COMPOUND WITH ELECTRIC ACCESS AND CCTV**  
**SELF STORAGE**  
 \$120.00/MONTH INDOOR  
 \$60.00/MONTH OUTDOOR  
 MAY SPECIAL 5% OFF  
**Call us! 204.389.2023**  
 40 Hamilton Winnipeg Beach



**SAVE  
UP TO  
\$1,000\***  
on select models

**FINANCE  
FROM  
1.99%\***  
for 24 months on select models

**NO FINANCE  
PAYMENTS  
FOR UP TO  
90  
DAYS**

**HONDA**

**Honda Off-Road Motorcycles**



**HONDA**



**HONDA**

**\$500\***  
IN BONUS BUCKS  
off the purchase of  
2024 Rubicon 700

**FINANCE FROM  
1.99%\***  
for 24 months on all  
2024 ATV models

**NO FINANCE  
PAYMENTS  
FOR UP TO  
90  
DAYS**



**\$250\***  
IN BONUS BUCKS  
on most 2025  
ATV models

**FINANCE FROM  
2.99%\***  
for up to 60 months  
on select 2025  
ATV models

**HONDA**

**Call for extra Farm Commercial discounts.**

**SHACHTAY**  
**SALES & SERVICE LTD.**  
[www.shachtay.com](http://www.shachtay.com)

**204-376-5233**

*Servicing the  
Interlake for 58 Years!*

**Arborg, Manitoba**  
Family Owned